

ER (M) – Spanners



Model of Spanners	Type of nuts
ER8M	ER8M
ER11M	ER11M
ER16M	ER16M
ER20M	ER20M

ER (A / Hex) – Spanners



Model of Spanners	Type of nuts
ER8A	ER8A
ER11A	ER11A
ER16A	ER16A
ER20A	ER20A
ER25A	ER25A

ER (UM) – Spanners



Model of Spanners	Type of nuts
ER16	ER16UM
ER20	ER20UM
ER25	ER25UM
ER32	ER32UM
ER40	ER40UM
ER50	ER50UM

C – Spanners



Model of Spanners	Type of Chuck
C-ER25	1/2" Light
C-ER32	1/2" Heavy
C-ER40	5/8", 3/4", Heavy
KEYLESS CHUCK	1/2" HEAVY

3D-Taster / 3D Edge Fider



AXIS	SHANK DIA	ACCURACY	STYLUS
X, Y, Z	20 MM	0.01MM	33MM L X 4 MM DIA

Centering Indicator

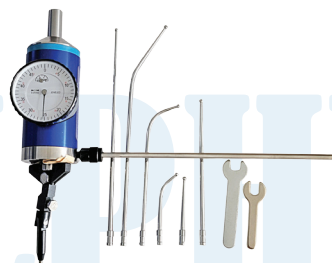

RANGE	ACCURACY
0-3 MM	0.01MM

Z – Axis Scale Zero Setters with Magnetic base

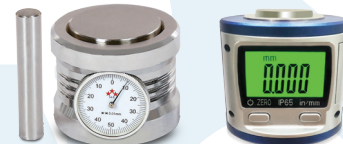

MODEL	Gross Attitude
DIAL TYPE (0.01MM)	50MM
DIGITAL (0.001 MM) IP 65 SERIES	50MM

Pull Studs – Regular / Through Coolant

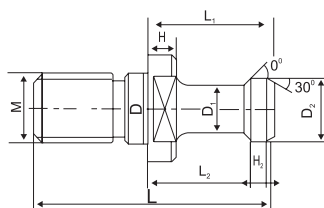

MODEL	L	L1	L2	D	D1	D2	H	H1	M	θ
BT30 (θ)	43	23	18	12.5	7	11	5	2.5	M12	45 60 90
BT40 (θ)	60	35	28	17	100	15	6	3	M16	45 60 90
BT50 (θ)	85	45	35	25	17	23	10	5	M24	45 60 90

Pull studs in SK/CAT/ other DIN specifications available against order

Master Mandrel (Spindle Tester)



Co-centricity 0.003mm

RANGE
BT40 DIA 40mm – 300mm Long
BT50 DIA 50mm – 300mm Long