

## Cylindrical Collet Adaptor

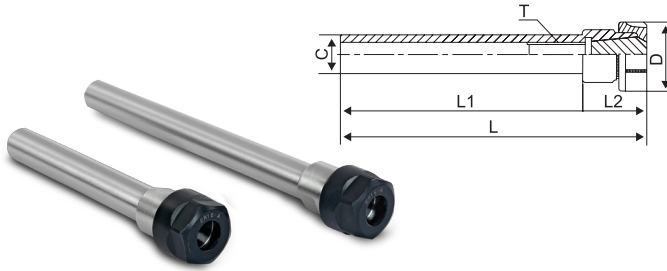

MODEL	L1	C	D
C10-ER8 A/M-100/150/200	100/150/200	10	14/12
C10-ER11 A/M-100/150/200	100/150/200	10	19/16
C12-ER11 A/M-100/150/200	100/150/200	12	19/16
C12-ER16 A/M-100/150/200	100/150/200	12	28/22
C16-ER11 A/M-100/150/200	100/150/200	16	19/16
C16-ER16 A/M-100/150/200/250/300	100/150/200/250/300	16	28/22
C20-ER16 A/M-100/150/200	100/150/200	20	28/22
C20-ER20 A/M-100/150/200/250/300	100/150/200/250/300	20	34/28
C20-ER25 UM-100	100	20	42
C25-ER16 A-100	100	25	28
C25-ER20 A-100	100	25	34
C25-ER25UM-100/150/200/250	100/150/200/250	25	42
C25-ER32UM-100	100	25	50
C32-ER16 A-100	100	32	28
C32-ER20 A-100	100	32	34
C32-ER25UM-100	100	32	42
C32-ER32UM-100/150/200	100/150/200	32	50
C32-ER40UM-100	100	32	63
C40-ER16A-100	100	40	28
C40-ER20 A-100	100	40	34
C40-ER25UM-100	100	40	42
C40-ER32UM-100	100	40	50
C40-ER40UM-100/150/200	100/150	40	63

## BT Series ER Collet Adaptor

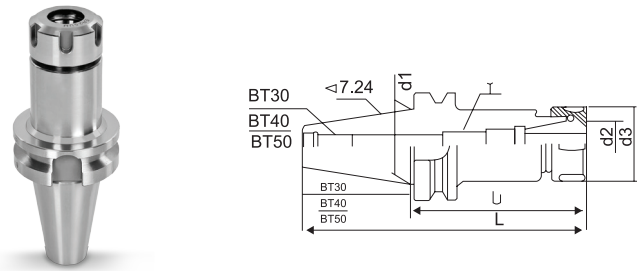

MODEL	L1	D3	D1
BT30-ER11 A/M-70/100	70/100	19/16	31.75
BT30-ER16 A/M-70/100	70/100	28/22	31.75
BT30-ER20A-70/100	70/100	34	31.75
BT30-ER25UM-70/100	70/100	42	31.75
BT30-ER32UM-70/100	70/100	50	31.75
BT30-ER40UM-80/100	80/100	63	31.75
BT40-ER11 A/M-70/100/150	70/100/150	19/16	44.25
BT40-ER16 A/M-70/100/150/200/250/300	70/100/150/200/250/300	28/22	44.25
BT40-ER20A-70/100/150/200/250/300	70/100/150/200/250/300	34	44.45
BT40-ER25UM-70/100/150/200/250/300	70/100/150/200/250/300	42	44.45
BT40-ER32UM-70/100/150/200/250/300	70/100/150/200/250/300	50	44.45
BT40-ER40UM-80/100/150/200/250/300	80/100/150/200/250/300	63	44.45
BT50-ER16 A-100/150/200/250/300	100/150/200/250/300	28	69.85
BT50-ER20 A-100/150/200/250/300	100/150/200/250/300	34	69.85
BT50-ER25UM-100/150/200/250/300	100/150/200/250/300	42	69.85
BT50-ER32UM-100/150/200/250/300	100/150/200/250/300	50	69.85
BT50-ER40UM-100/150/200/250/300	100/150/200/250/300	63	69.85
BT50-ER50UM-100/150	100/150	73	69.85

## BT - Side Lock Adaptor

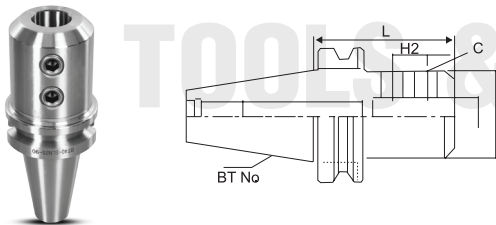

Model	L	C	Model	L	C
BT30-SLA 16	65	50	BT40-SLA 25	60/100/150/200	65
BT30-SLA 20	70	52	BT40-SLA 32	60/100/150/200	72
BT30-SLA 25	75	65	BT40-SLA 40	110/150/200	90
BT30-SLA 32	90	72	BT50-SLA 16	65	50
BT40-SLA-10	65	45	BT50-SLA 20	70	52
BT40-SLA-12	70	45	BT50-SLA 25	100/150/200	65
BT40-SLA16	65	50	BT50-SLA 32	105/150/200	72
BT40-SLA 20	70	52	BT50-SLA 40	110/150/200	90
BT40-SLA 22	90	52	BT50-SLA 50	120	100

## BT - MT (Reduction Socket) Adaptor

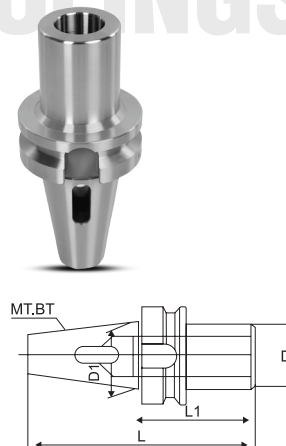

MODEL	L	D	D1
BT30-MT1-50	95	25	25.00
BT30-MT2-60	108.4	32	31.75
BT30-MT3-70	128.4	40	31.75
BT40-MT1-50	110.4	25	25.00
BT40-MT2-60	125.4	32	44.45
BT40-MT3-70	135.4	40	44.45
BT40-MT4-90	155.4	48	44.45
BT50-MT2-45	146.8	25	69.85
BT50-MT3-65	166.8	40	69.85
BT50-MT4-90	186.8	48	69.85
BT50-MT5-105	196.8	63	69.85