

CKB MICRO BORING HEADS FINE BORING EWN SERIES

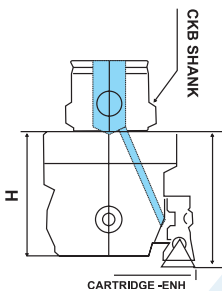

Model / Range	Cartridge	Internal Boring Range	Counter Boring Range	Insert	H (Height)
CKB-1, EWN 20MM-36MM	ENH1-1	20-26		TPGT-08	32
	ENH1-2	25-31	30-31		
	ENH1-3	30-36	30-36		
CKB-2, EWN 25 MM - 47 MM	ENH2-1	25-33			37
	ENH2-2	32-40	36-47		
	ENH2-3	39-47	39-47		
CKB-3, EWN 32 MM- 60 MM	ENH3-1	32-42		37	
	ENH3-2	41-51	46-51		
	ENH3-3	50-60	50-60		
CKB-4, EWN 40MM-79MM	ENH4-1	41-54		TPGT-11	47
	ENH4-2	53-66	58-66		
	ENH4-3	61-74	61-74		
CKB-5, EWN 53MM-95MM	ENH5-1	53-70	62-70		56
	ENH5-2	68-85	69-85		
	ENH5-3	78-95	78-95		
CKB-6, EWN 68MM-150MM	ENH6-1	68-100	80-100	66	
	ENH6-2	93-125	93-125		
	ENH6-3	125-150	125-150		
CKB-6, EWN 100MM-203MM	ENH7-1	100-153	112-153	66	
	ENH7-2	125-178	125-178		
	ENH7-3	150-203	150-203		

TWIN CUTTER – ROUGH BORING HEADS – TWN SERIES

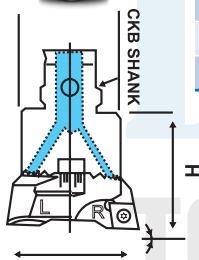

MODEL / RANGE	H	INSERT
CKB-1 TWN 19MM-26 MM	30	CCMT06020
CKB-2 TWN 25MM-33MM	35	CCMT06020
CKB-3 TWN 32MM-42 MM	40	CCMT06020
CKB-4 TWN 40MM-55 MM	50	CCMT09T30
CKB-5 TWN 52MM-70 MM	60	CCMT09T30
CKB-6 TWN 68MM-92 MM	70	CCMT12040
CKB-6 TWN 90MM-122 MM	85	CCMT12040
BST -TWN 120MM-164MM	95	CCMT12040

ADAPTORS FOR FINE BORING HEADS



MODEL / RANGE
BT 40 CKB 1 X 100 L
BT 40 CKB 1 X 130 L
BT 40 CKB 2 X 100 L
BT 40 CKB 2 X 165 L
BT 40 CKB 3 X 100 L
BT 40 CKB 3 X 165 L
BT 40 CKB 4 X 100 L
BT 40 CKB 4 X 150 L
BT 40 CKB 5 X 100 L
BT 40 CKB 5 X 150 L
BT 40 CKB 6 X 100 L
BT 40 CKB 6 X 150 L
BT 40 BST-100 L

*Other sizes of BT40/BT50 CKB Adaptors not mentioned above available on request

CNC Live Centers (Stub or extended point)

Available in carbide tipped points also

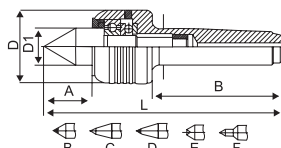

Model	A	B	D	D1	L	Max load	Max Speed	Accu-ry
MT2	28	65	46	24	140	100	3500	0.01
MT3	38	81	59	28	170	250	3000	0.015
MT4	45	102	64	31	198	400	2500	0.015
MT5	52	130	78	44	245	700	2000	0.02

CNC Interchangeable Points Live Centers

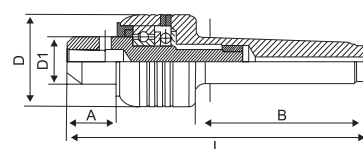

Model	A	B	D	D1	L	Max load	Max Speed	Accuracy
MT2	27	65	46	24	140	100	3500	0.01
MT3	32	81	59	28	170	250	3000	0.015
MT4	34.5	102	64	31	198	400	2500	0.015
MT5	44	130	78	44	245	700	2000	0.02

Supplied with one Spare Point + One Drift